



**Two-Stage Snow Blower
For 4WD Pick Up Trucks**

Operator's Manual

Distributed by:
Metal Fabricating LLC
P.O. Box 831
Brodheads ville, PA 18322
Phone: 570-992-9989
SnowVac.com

WARRANTY POLICY

Metal Fabricating LLC (SnowVac) products are warranted for a period of nine (9) months (90 days for commercial application) from original date of purchase, by original purchaser, to be free from defects in material and workmanship under correct, normal use and proper applications.

The above warranty does not extend to goods damaged or subject to accident, abuse or misuse after shipment from SnowVac's factory, nor to goods altered or repaired by anyone other than an authorized SnowVac representative

Metal Fabricating LLC (SnowVac) makes no Express Warranties other than those, which are specifically described. Any description of goods, including any references and specifications in catalogues, circulars and other written material published, is for the sole purpose of identifying goods and shall conform to such descriptions. Any sample or model is for illustrative purposes only and does not create an Express Warranty that the goods conform to sample or model shown.

The purchaser is solely responsible for determining suitability of goods sold. This warranty is expressly in lieu of all other warranties expressed or implied. SnowVac will in no event be liable for any incidental or consequential damages whatsoever. Nor for any sum in excess of the price received for the goods for which liability is claimed.

IMPORTANT FACT:

Snowblower Fan Shafts Carry No Warranty

IMPORTANT NOTE:

This warranty does not apply to rentals

Take note! This safety alert symbol, found throughout this manual is used to call your attention to instructions involving your personal safety and the safety of others. Failure to follow these instructions can result in injury or death.



These symbols mean Attention, Become Alert, Your safety is involved!

Signal Words: Note the use of the signal words **Danger**, **Warning** and **Caution** with the safety messages. The appropriate signal word for each has been selected using the following guidelines:

Danger: Indicates an imminently hazardous situation that, if not avoided, will result in death or serious injury. This signal word is to be limited to the most extreme situations typically for machine components, which, for functional purposes, cannot be guarded.

Warning: Indicates a potentially hazardous situation that, if not avoided, could result in death or serious injury, and includes hazards that are exposed when guards are removed. It may also be used to alert against unsafe practices.

Caution: Indicates a potentially hazardous situation that, if not avoided, may result in minor or moderate injury. It may also be used to alert against unsafe practices.

If you have any questions not answered in this manual or require additional copies or the manual is damaged, please contact your dealer or

For your safety you must not operate, service, inspect or otherwise handle this equipment unless you have read the Owner's Manual and have been properly trained in its intended usage.

Keep hands, feet and clothing away from power driven parts in motion.

Never make adjustments or lubricate the machine while it is in motion.

Never allow children to operate this equipment.

Do not operate on terrain that is so steep that rollover could occur.

Make sure that your vehicle has adequate ballast for stability.

See your vehicle Owner's Manual.

Use adequate safety warning lights and devices as required by local regulations.

Require anyone who will operate this machine to read and understand the "Operator's Manual."

Give necessary instructions.

Be sure this "Operator's Manual" is made available to them and that they have been instructed in safe operating procedures.

Failure to heed may result in personal injury or death

Additional copies are available from the manufacturer.

Safety Sign Decals on All Units

The types of Safety Signs on the equipment are shown in the illustrations following. Good safety requires that you familiarize yourself with the various Safety Signs, the type of warning and the area, or particular function related to that area that requires your safety awareness.



These warning stickers must be always displayed on your snow blower. If they are missing or not readable, contact the factory for replacements.

Safety Sign Decals, continued

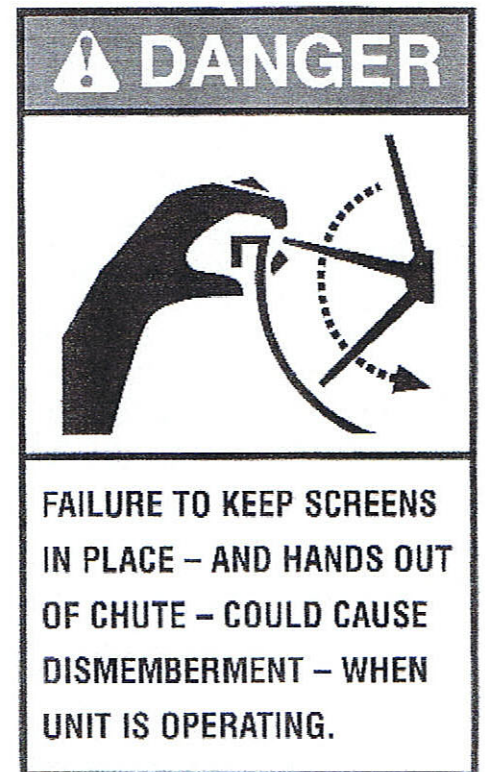
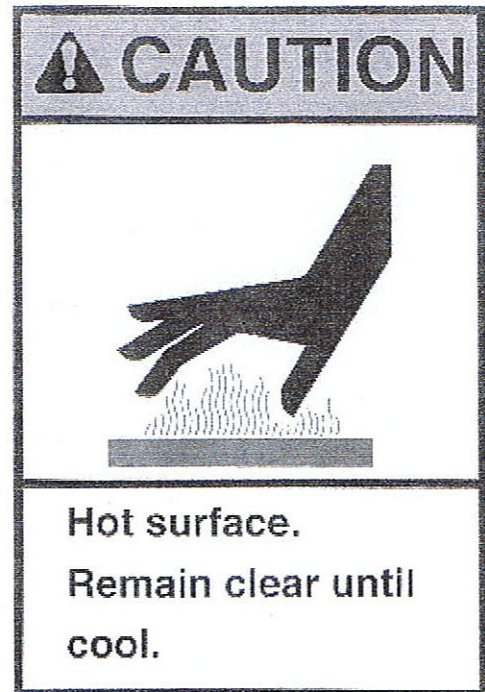
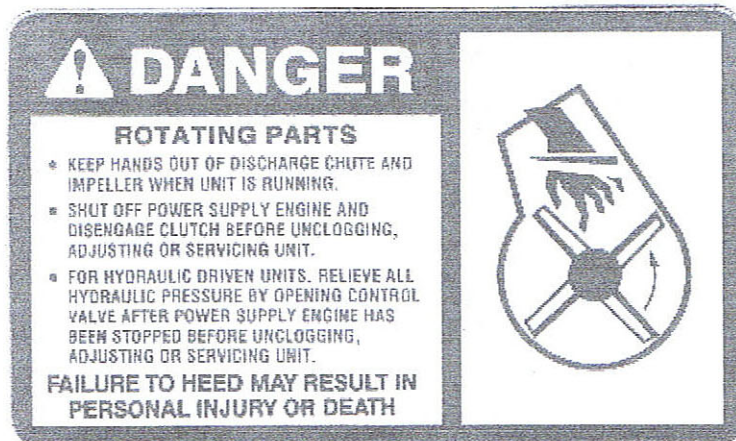

If Safety Sign decals have been damaged, removed, become illegible or parts have been replaced without decals, new decals must be applied. New decals are available from your authorized distributor or factory.



SAFETY...YOU CAN LIVE WITH IT

EQUIPMENT SAFETY GUIDELINES

Safety of the operator is one of the main concerns in designing and developing a new piece of equipment. Designers and manufacturers build in as many safety features as possible. However, every year many accidents occur which could have been avoided by a few seconds of thought and a more careful approach to handling equipment. You, the operator, can avoid many accidents by observing the following precautions in this section. To avoid personal injury, study the following precautions and insist those working with you, or for you, follow them.

In order to provide a better view, certain photographs or illustrations in this manual may show an assembly with a safety shield removed. However, equipment should never be operated in this condition. Keep all shields in place. If shield removal becomes necessary for repairs, replace the shield prior to use.

Replace any CAUTION, WARNING, DANGER or instruction safety decal that is not readable or is missing. Location of such decals is indicated in this booklet.

Do not attempt to operate this equipment under the influence of drugs or alcohol.

Review the safety instructions with all users annually.

This equipment is dangerous to children and persons unfamiliar with its operation. The operator should be a responsible adult familiar with machinery and trained in this equipment's operations. Do not allow persons to operate or assemble this unit until they have read this manual and have developed a thorough understanding of the safety precautions and of how it works.

To prevent injury or death, do not paint over, remove or deface any safety signs or warning decals on your equipment. Observe all safety signs and practice the instructions on them.

Never exceed the limits of machinery. If its ability to do a job, or to do so safely, is in question – Do not try it.



DANGER

Augers can crush or dismember. Keep well clear and keep others away when unit is running.

Keep hands out of discharge chute and impeller when unit is running.

Shut off power supply engine and disengage clutch before unclogging, adjusting or servicing unit.

For hydraulic driven units, relieve all hydraulic pressure by opening control valve after power supply engine has been stopped before unclogging, adjusting or servicing unit.

Keep all shields, guards and covers in place.



WARNING

Know how to stop all equipment operation in case of emergency.

Direct snow to open areas only. Never direct discharge at bystanders, vehicles or buildings, foreign objects or ice chunks in snow may be thrown much further than expected.

Do not operate when blowing snow restricts visibility.

Keep people away from machine and discharge area. Never allow anyone in front of unit.

Stop Power Supply Engine before leaving the operator's seat.

Thoroughly inspect the area where the equipment is to be used and remove all debris, boards, wire, steel and other foreign objects.

SAFETY

Remember, YOU are the key to safety. Good safety practices not only protect you, but also the people around you. Make these practices a working part of your safety program. Be certain that everyone operating this equipment is familiar with the recommended operating and maintenance procedures and follows all the safety precautions. Most accidents can be prevented. Do not risk injury or death by ignoring good safety practices.

The alert symbol is used throughout this manual. It indicates attention is required and identifies hazards. Follow the recommended precautions.



The safety alert symbol means...

ATTENTION! BECOME ALERT! YOUR SAFETY IS INVOLVED!



CAUTION

The caution symbol indicates a potentially hazardous situation that, if not avoided, may result in minor or moderate injury. It may also be used to alert against unsafe practices.



WARNING

The Warning Symbol indicates a potentially hazardous situation that, if not avoided, could result in death or serious injury, and includes hazards that are exposed when guards are removed. It may also be used to alert against unsafe practices.



DANGER

The Danger Symbol indicates an imminently hazardous situation that, if not avoided will result in death or serious injury. This signal word is to be limited to the most extreme situations, typically for machine components that, for functional purposes, cannot be guarded.

Do not allow anyone to stand behind the snowblower or in the area of discharged snow

GENERAL SAFETY

Have a first-aid kit available for use and know how to use it.

Have a fire extinguisher available, stored in a highly visible location, and know how to use it.

Wear appropriate protective gear. This list may include but is not limited to:

- Hard hat
- Protective shoes with slip resistant soles
- Protective glasses or goggles
- Heavy gloves
- Wet weather gear
- Hearing protection
- Respirator or filter mask

Read and understand the Operator's Manual and all safety signs before operating, servicing, adjusting, repairing, or unplugging the equipment.

Do not attempt any unauthorized modifications to your Snowvac product as this could affect function or safety, and could affect the life of the equipment.

Never start or operate the snowblower except from the operator's station on the power unit.

Inspect and clean the working area before operating.

Keep hands, feet, clothing, and hair away from moving parts.

Ensure bystanders are clear of the area before operating.

START-UP SAFETY

Do not let inexperienced operators or children run this equipment.

Do not operate inside a building unless there is adequate ventilation.

Ensure all shields are in place and in good condition before operating.

OPERATION SAFETY

Do not permit riders.

Do not wear loose fitting clothing during operation.

Stay clear of Snowblower augers.

Stay clear of Snowblower discharge chute. Rocks or debris can be picked up and thrown.

Never operate the equipment in the raised position.

TRANSPORT SAFETY

Check with local authorities regarding transport on public roads. Obey all applicable laws and regulations.

Make sure the SMV (Slow Moving Vehicle) emblem and all the lights and reflectors that are required by the local highway and transport authorities are in place, are clean, and can be seen clearly by all overtaking and oncoming traffic.

Never have the equipment in operation during transport.

Always travel at a safe speed.

SERVICE AND MAINTENANCE SAFETY

Stop engine, set brake, remove ignition key, and wait for all moving parts to stop before servicing, adjusting, repairing, or unplugging.

Support the equipment with blocks or safety stands before working beneath it.

Follow good shop practices including

- Keep service area clean and dry

- Be sure electrical outlets and tools are properly grounded

- Use adequate light for the job

Use only tools, jacks, and hoists of sufficient capacity for the job.

Replace and secure all shields removed during servicing before operating.

Use heavy leather gloves to handle sharp objects.

Check hydraulics regularly for leaks. Use cardboard to look for leaks, and use hand and eye protection.

Relieve pressure on hydraulic system before repairing or adjusting.

STORAGE SAFETY

Store the unit in an area away from human activity.

Do not permit children to play on or around the stored machine.

Support the frame on stands and blocks to provide a secure base.

SAFETY SIGNS

Keep all safety signs clean and legible and replace any that are damaged or missing.

When original parts are replaced, any safety signs affixed to those parts should be replaced as well. Replacement safety signs are available from your local dealer.

General Information

PRE-OPERATION INSPECTION

Check fuel levels and refuel when equipment is cold. This will also avoid inconvenience later. Attach the Snow Blower to your vehicle in accordance with the instructions for INSTALLATION. Check oil Lubricant levels.



WARNING: Inspect all bolted connections and attachments to be sure that they are properly tightened. Failure to do so may result in personal injury or death. Skids on each side of the main body must be lowered to eliminate rocks or any other debris from entering impeller assembly.



WARNING: Thoroughly inspect the area where the equipment is to be used and remove all debris, boards, wire, steel and other foreign objects. Failure to heed may result in personal injury or death.

SNOWBLOWER CONTROLS



WARNING: Maintain all safety devices (such as emergency shut-off switches) in working order. Failure to do so may result injury or death.

Your unit has electric controls installed for controlling the rotation of the Discharge Chute and vertical adjustment of the Chute Deflector. You can make these adjustments "on the go" by actuating the Toggle Switch which regulates that adjustment.

SNOW REMOVAL PROCEDURES



WARNING: Direct snow to open areas only. Never direct discharge at bystanders, vehicles or buildings. Failure to heed may result in personal injury or death.



WARNING: Keep windows clear to provide good visibility. Failure to heed may result in personal injury or death. Do not try to direct snow discharge upwind. Always set discharge downwind.



DANGER: Auger can crush or dismember. Keep well clear and keep others away when unit is running. Failure to heed may result in personal injury or death.



DANGER: Keep hands out of discharge chute and impeller when unit is running. Failure to heed may result in personal injury or death.



DANGER: Shut off Power Supply Engine before unclogging, adjusting or servicing unit. Never attempt to service or approach the snow blower when it is running. For hydraulic driven units, relieve all pressure by opening control valve after power supply engine has been stopped before unclogging, adjusting or servicing unit. Failure to heed may result in injury or death.

SNOW REMOVAL PROCEDURES, continued

Snow removal should be done before excessive snow accumulation results. If snow is removed promptly less power will be required, the job will be easier and quicker, and the strain to the equipment will be reduced.

Snow left sitting picks up moisture, becomes heavier and more difficult to handle and may freeze together in a mass.

Be prepared for the job. If your tractor or vehicle will require chains for traction, install them.

Your Snow Blower provides for turning of the Discharge Chute to direct snow either left or right and the Chute Deflector can be adjusted up or down for best operation. Standard controls are manual. Optional electric controls are available for added convenience.

Some things you should know if the snow blower becomes clogged:

It is anticipated that at some time it may be necessary for you to clean out or unclog your snow blower. You must practice some safety procedures to accomplish this and some reasons that may not be readily obvious are presented. It just makes good sense that you should not attempt any kind of service with the Power Source Engine running. Furthermore it is possible that when plugged there may be strain on the impeller, auger or drive shaft. This is particularly true if a jam-up or clog has been caused from pinching or catching a foreign object in the mechanism. This pressure or strain must be eliminated by disengagement of the clutch to the snow blower. If the unit is hydraulically driven, relieve pressure by shutting off the Power Supply Engine and then opening the control valve to release stored energy. If this is not done, you may be in danger of receiving serious injury from any of these parts suddenly moving when the obstruction is removed.

Engine Starting and Operating Instructions for 27HP Kohler Engines

Important! For proper break-in on your new engine, allow it to idle for 15 minutes the first time it is started. This is only recommended for the first running period.

The throttle switch is solenoid activated and it controls low speed and high speed RPM settings.

Always start the engine in low speed RPM setting.

As soon as engine is warmed up, push toggle switch to high speed RPM setting.

Never blow snow in low speed RPM setting as damage to solenoid may occur.

Be sure to turn the start key off when snow blower is not in use.

ASSEMBLY INSTRUCTIONS

Mount the discharge spout (#6) using the spout clamps (#59) bolted to the spout ring on the snowblower. Lubricate the spout ring and clamps.

OPERATING INSTRUCTIONS

1. Do not operate the blower in the fully raised position. Damage may occur to Snowblower if angle becomes more extreme.
2. Run the blower at low rpm to check operation before blowing snow.
3. Shear bolts should be fastened with a lock nut or two jam nuts.

These bolts must be kept tight to prevent wear of the bolt and bolt holes.
4. Chain tension: Slack on the lower side of the chain should be 3/8 to 1/2 inch.
5. Periodically check all bolts for tightness. The bolts holding on the fan and the bearing bolts are of particular importance.
6. Shear Sprocket: The Shear Sprocket (#52) should be checked at the beginning of every season to make sure it will spin freely. With time this sprocket could corrode and seize which will not allow the shear bolt to break if something jams in the snowblower auger. Clean to loosen if necessary.

Lubrication

- a) The spout clamps and rings should be periodically lubricated with gun grease.
- b) Regularly oiling the chain will significantly increase the life of the chain.
- c) The grease fitting on the hydraulic spout swivel arm should be kept lubricated.

Fuel Tank Placement

Fuel tank should be located in rear of truck. Use fuel line, clamps, squeeze bulb, fittings etc. to supply fuel to engine fuel line coupler located at base of engine mounting plate.



Professional Installer should provide 1 PIECE of 5/16" Fuel Line (not included - locally obtainable) to avoid leaks. Do not use splices, or couplers to make length.

Caution should be used when routing and securing fuel lines.
Add at least two gallons of good gasoline to the fuel tank.

YOU MUST REMOVE FUEL TANK TO REFILL

Fuel Container Hold-Down Kit - Shown Below

This hold-down kit is manufactured from poly strapping to provide superior strength and good looks. The quick release buckle makes it simple to remove and replace container. The hold-down strap unit comes complete with two 62" poly straps equipped with quick release buckles and four footman loops and mounting hardware.

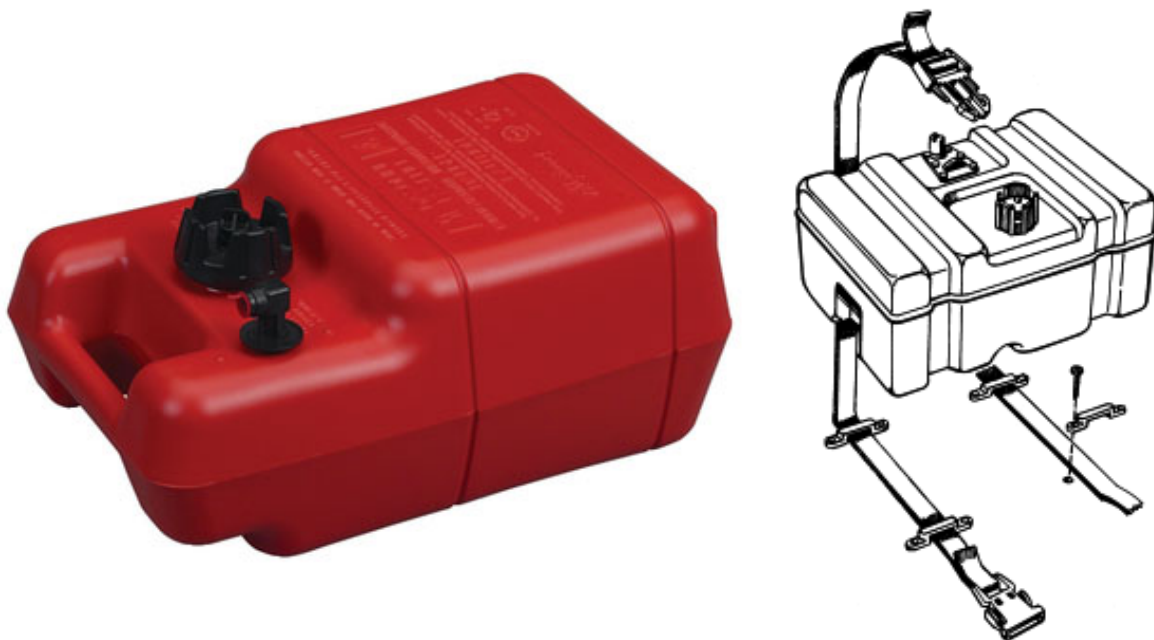

Important Operation Detail:

Kohler 27 HP Engine

To Operate:

For cold weather operation, below 45° F (7° C), move the slide lever on the air cleaner base towards the blower housing (closed position). For temperatures above 45° F (7° C), the slide must be moved towards the rear of the blower (open position). Failure to do so may result in poor operation, internal engine damage, and/or non compliant exhaust emission levels.

NOTE: These instructions should be retained by the end user for referral when seasonal conversion is necessary.

In-Cab Controls

1. Do a visual walk around of snowblower to make sure no ice, or foreign objects are in or around blower.
2. Make sure blower is lowered and on ground (before starting)
3. Turn Key On, wait 6 seconds
4. Press and hold Choke Button On Remote.
5. Turn Key Start, and then release choke button.

3 Ways to Stop Snowblower

1. Turn Off Main Power Key Switch - Remove Key
2. Push Emergency Stop Button on Remote Control
3. Emergency Stop Pull Switch mounted on outside of Blower shown on right ----->

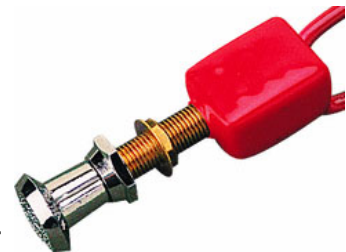

INSTALLATION OF KEY SWITCH HARNESS AND POWER CABLES WITH SOLENOID:

- 1- REMOVE WIRES FROM KEY SWITCH AND NOTE THEIR PREVIOUS POSITION.**
- 2- MOUNT KEY SWITCH AND MOUNTING BRACKET UNDER VEHICLE'S DASH (BE CAREFUL WHEN RUNNING WIRES THROUGH FIREWALL).**
- 3- MOUNT SOLENOID IN UP POSITION. (SEE LABEL TOP). DO NOT LAY FLAT.**
- 4- CONNECT THE ONE LARGE AND ONE SMALL CABLE, MARKED "+ POSITIVE" TO THE POSITIVE TERMINAL ON VEHICLE BATTERY.**
- 5- CONNECT THE ONE LARGE AND ONE SMALL CABLE, MARKED "- NEGATIVE" TO THE NEGATIVE TERMINAL ON THE VEHICLE BATTERY.**
- 6- ROUTE THE GRAY 4-WIRE W/CONNECTOR THROUGH TO THE FRONT OF THE VEHICLE GRILL. THIS WIRE WILL MATE WITH THE SNOW VAC'S GRAY 4-WIRE CABLE W/TERMINAL.**

KEY SWITCH WIRING DIAGRAM:

WHITE WIRE GOES TO TERMINAL M

ORANGE WIRE GOES TO TERMINAL B

GREEN WIRE GOES TO TERMINAL M

BLACK WIRE GOES TO TERMINAL S

RED WIRE GOES TO TERMINAL 4 (THIS IS THE DOUBLE TERMINAL).

KEY SWITCH HARNESS WITH POWER CABLES AND SOLENOID

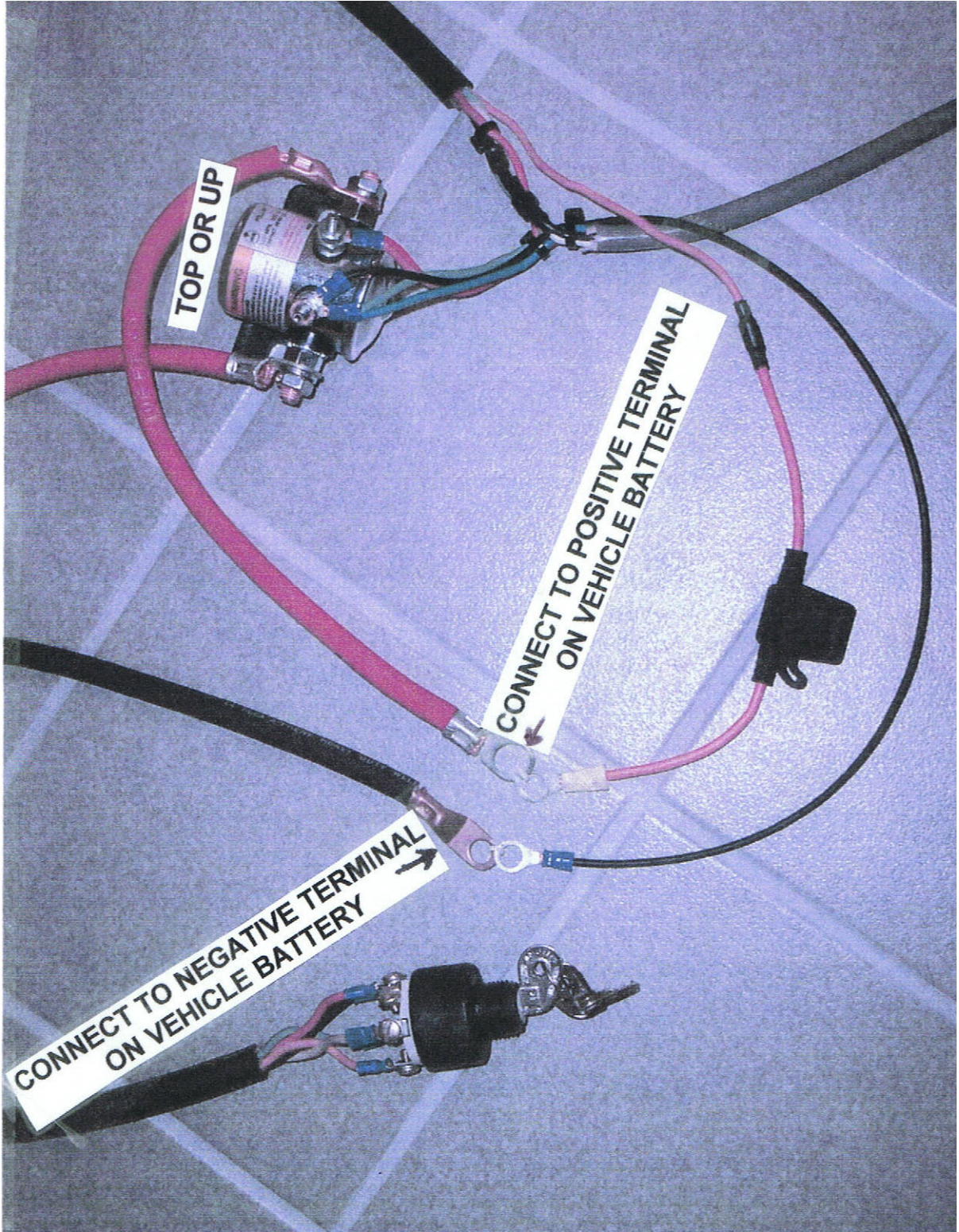



4.0 Base Unit/Handheld Communication

A standard SMART System consists of one handheld remote and one base unit. Each base unit is capable of communicating with up to eight handheld remotes. Each handheld must first establish a communications link with the base unit before the base unit will recognize the handheld unit. This process is called Association.

Note: Base Unit uses 3 AAA Batteries

4.1 Base Unit/Handheld Association

Base unit and handheld Association is established using the following steps:

1. Remove power from the base unit.
2. Stand near the base unit in line of sight with the handheld in your hand.
3. Simultaneously press and hold Button 1 (Associate) and Button 2 (Disassociate) (see Figure 13). The TX LED lights steady green.
4. Continue to hold both buttons for the five seconds it takes for the LINK LED to begin flashing amber.
5. When the LINK LED flashes amber, release the two buttons. The RX LED flashes red allowing two (2) seconds for you to make the next button press.

✓ **Note:** *If the next button press is not performed within the two second interval that RX flashes red, the Association procedure is aborted and must be started anew to establish the communication link.*

6. Press and hold Button 1 (Associate; see Figure 13). The RX LED extinguishes. The TX LED lights steady green and the LINK LED lights steady amber.
7. Apply power to the base unit while continuing to hold the Associate button.

The base unit and handheld begin to establish a communication link while the Associate button is held. Once the process is complete, the amber LINK LED extinguishes; the RX LED begins flashing red; the TX LED lights steady green and remains so until the Associate button is released.

8. Release the Associate button.

The RX LED extinguishes, the TX LED flashes green for a brief time and then it too goes out. The SMART System is ready for use with that particular handheld remote.

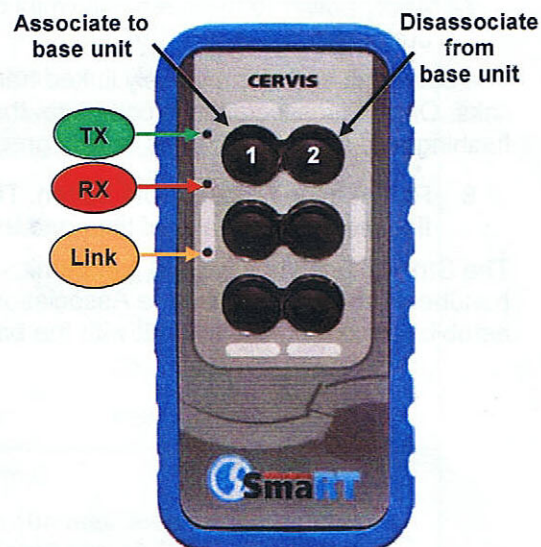
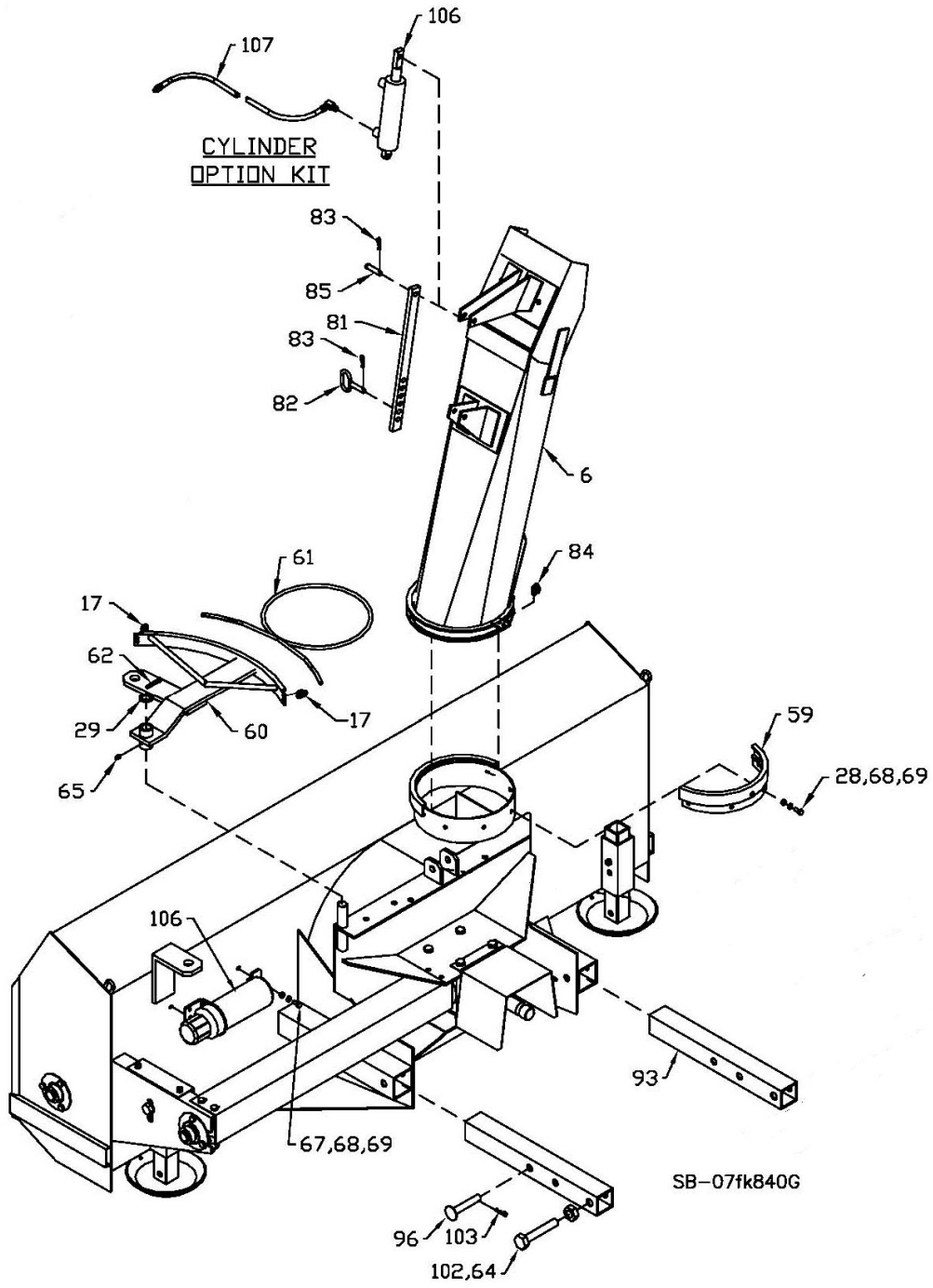

Figure 13. Associate/Disassociate Buttons



Some parts listed below may not be used on your snowblower

ITEM	PART #	DESCRIPTION
1	907241	Main Body (#740)
	907235	Main Body (#840)
	907240	Main Body (#840G)
2	907244	Stand Weldment - 8" Tall
3	965294	Stand Pin Weldment 9/16" x 2 7/8"
4	F0463	Hitch Weldment (Category 1 & 2)
5	965803	Hand Crank
6	965653	Discharge Spout
7	965927	3/16" Cable x 100" Long
8	F842	PTO Shaft (Standard)
	F844	PTO Shaft (Optional Long)
9	907213	Bottom Tube Weldment 20 5/8" Long
10	81676	5/8" Hex Nut
11	81677	5/8" Lock Washer
12	81620	1/2" x 1 1/4" Hex Bolt
13	81636	1/2" Hex Nut
14	81637	1/2" Lock Washer
15	81627	1/2" x 3" Hex Bolt
16	965821	3/8" x 1 3/4" Key
17	965806	3/16" Cable Clamp
18	965807	Top Link Pin (Category 1)
19	965808	Top Link Pin Bushing (Category 1-2)
20	907214	A-Frame - LH (Category 1)
21	907215	A-Frame - RH (Category 1)
22	965911	7/16" Linch Pin
23	84277	1/2" x 1 1/2" Hex Bolt
24	84072	3/8" x 3/4" Hex Bolt
25	81593	3/8" Lock Washer
26	81592	3/8" Hex Nut
27	81638	1/2" B.S. Flat Washer
28	812026	5/16" x 1" Hex Bolt
29	967140	1" x 10Ga Narrow Rim Washer
30	902377	Fan Key - 3/8" x 4 3/4"
	965814	3/8" x 4 1/4" Key (#840G Only)

31	965835	Fan Shaft, 1 1/2" x 16 3/4"
32	965816	Bevel Gear - 1 1/4" Bore
33	965817	Bevel Gear - 1 1/2" Bore
34	965818	1 1/4" Bearing w/ Collar
35	961637	Bearing Retainer (Set)
36	86170	3/8" x 1" Hex Bolt
37	901940	5/16" x 1 1/4" Key (#740 & #840)
38	965413	Drive Shaft (#740), 1 1/4" x 37 1/4"
	965402	Drive Shaft (#840), 1 1/4" x 42 1/4"
	965403	Drive Shaft (#840G), 1 1/4" x 34"
39	936402	PTO Safety Chain
40	81527	1/4" x 1" Hex Bolt
41	84498	1/4" Lock Nut
42	968627	1 1/2" Bearing With Collar
43	967260	1 1/2" Bearing Retainer
44	965822	Fan (Standard 3-Blade)
	965447	Fan (Optional 4-Blade)
45	965414	Auger (#740)
	965405	Auger (#840 & #840G)
46	965415	Drive Shaft Guard (#740)
	965404	Drive Shaft Guard (#840 & #840G)
47	907218	Hitch Tube Weldment 22"Long
48	965834	Idler Spacer, 5/8" Long
49	84111	1/2" x 1 1/4" Sq. Hd. Set Screw
50	984077	1/2" Jam Nut
51	965825	40 Tooth Sprocket, #50
52	965826	13 Tooth Sprocket, #50 (Shear)
53	965827	Roller Chain (#50 x 98 Link with Connector)
54	965844	15 Tooth Idler Sprocket, #50
55	86171	3/8" x 1 1/4" Hex Bolt
56	965917	1 3/8" Bearing With Collar
57	961675	Bearing Retainer (Set)
58	84289	5/8" x 3" Hex Bolt
59	965416	Spout Clamp
60	907820	Swivel Arm
61	965832	3/16" x 62" Cable
62	9812433	3/16" x 1 1/2" Cotter Pin
63	BU50506	Gearbox w/o Oil (#840G)
64	907674	7/8" Lock Nut
65	967164	Drive-In Grease Zirk
66	81619	1/2" x 1" Hex Bolt
67	81549	5/16" x 3/4" Hex Bolt
68	81569	5/16" Lock Washer
69	81568	5/16" Hex Nut

70	965968	Idler Shield
71	960135	PTO Shield Spring
72	87553	1/2" x 1 3/4" Hex Bolt
73	900712	Skid Pin Weldment
74	965409	PTO Shield (#840G)
	965410	PTO Shield (#740 & #840)
75	81523	1/4" x 1/2" Hex Bolt
76	81545	1/4" Lock Washer
77	81544	1/4" Hex Nut
78	812364	1/2" Lock Nut
79	988999	3/8" x 3/8" Socket Set Screw
80	907221	Upper Hitch Tube Weldment 21" Lg (Category 1 & 2)
81	965646	Spout Adjustment Bar
82	903523	1/2" x 1 1/2" Adjustment Pin Weldment
83	961012	#16 Hair Pin Clip
84	961658	1/4" Cable Clamp
85	961876	1/2" x 1 1/2" Clevis Pin
86	902407	Skid Plate Weldment
	F6707	Skid Plate Bundle
87	9812487	1 1/4" x 10ga Narrow Rim Washer
88	967110	1 1/4" x 14ga Narrow Rim Washer
89	9812439	1 1/4" x 18ga Narrow Rim Washer
90	967135	1 1/2" x 10ga Narrow Rim Washer
91	9812444	1 1/2" x 14ga Narrow Rim Washer
92	9812443	1 1/2" x 18ga Narrow Rim Washer
93	907250	Hitch Inner Tube 20 5/8" Lg (Category 1 & 2)
94	907315	Pin 7/8" x 7 3/4" (Category 1 & 2)
95	907316	Pin Sleeve 1 1/8" x 2 7/8"Lg (Category 1 & 2)
96	905821	Pin Rod 3/4" x 4 1/4"
97	84336	3/4" x 4" Hex Bolt
98	81701	3/4" Lock Washer
99	81700	3/4" Hex Nut
100	967361	7/8" x 4" Clevis Pin
101	966527	7/8" x 2 1/2" Hex Bolt
102	811826	7/8" x 5" Hex Bolt
103	12779	#9 Hair Pin Clip
104	81678	5/8" Flat Washer
105	909277	Manual Holder
106	24930	Cylinder 1.75"Dia x 5.0 - 9/16" ORB
107	115370	3/8" x 114" Hyd Hoses C/W Fittings

1.75 X 5 CYLINDER ASSEMBLY

Item #	Part #	Description
	24930	Cyl Complete
1	115367	Tube Weldt
2	112104	Shaft Weldt 1.0 Dia
3	X2669	Seal Kit

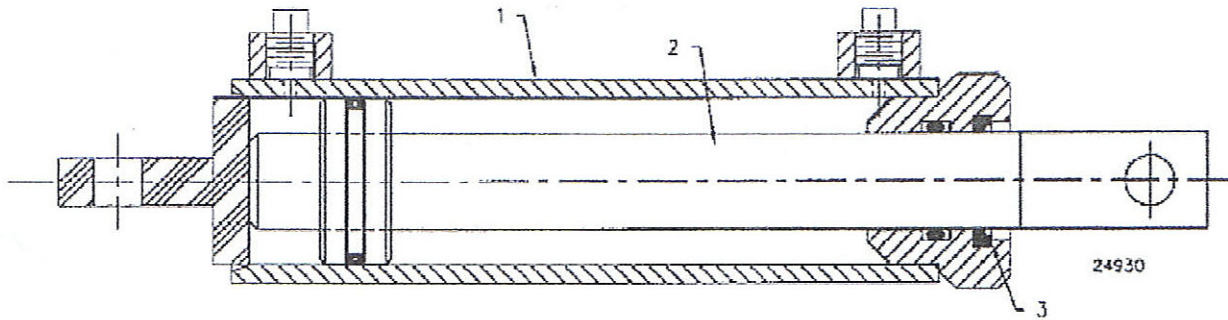

3.5 x 8 CYLINDER ASSEMBLY

Item #	Part #	Description
	24803	Cyl Complete
1	24804	Tube Weldt
2	113934	Piston Rod 1.5 Dia
3	X2098	Seal Kit

